



36-1418-AF

Tray & Rack Lifter

Models

36-1014-AF

36-1418-AF

36-1622-AF

36-2020-AF

36-1020-AF

36-1620-AF

Mobile, adjustable, cantilever-type, self-leveling dispenser for trays, cups or glasses. For use in serving lines or at hot and cold beverage service points.

FEATURES

- Stainless steel construction with push handle.
- Lift-out panel for easy access to dispensing mechanism.
- Full base for sanitary protection and empty rack or tray storage.
- Three-side access for versatility of service.
- Rack/tray carrier always remains level.
- Unit readily field adjustable to different load rates without tools.
- Base extends to rear (2½") for stability.
- Non-marking soft rubber 4" casters.
- Optional correctional package available.

PRODUCT INFORMATION

■ DISPENSING SYSTEM:

Easily field adjusted to a wide load range. By connecting the self-contained extension springs, the spring rate can be increased in increments of 1 lb./inch. Stainless steel carrier cannot bind or tip.

■ CAPACITIES (ALL MODELS):

To 125 trays, 14 dozen cups, 12 dozen glasses.

Total Load Capacity (all units) — 250 lbs.

Vertical Storage — Standard: 27½";

23" travel + 4½" to top of upright.

Optional 24½"; 20" travel + 4½" to top of upright.

Tray & Rack Lifter

36-1014-AF, 36-1418-AF, 36-1622-AF, 36-2020-AF, 36-1020-AF, 36-1620-AF

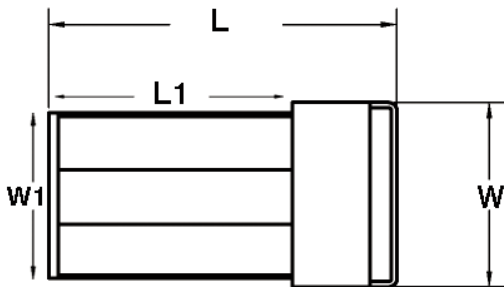

TOP VIEW

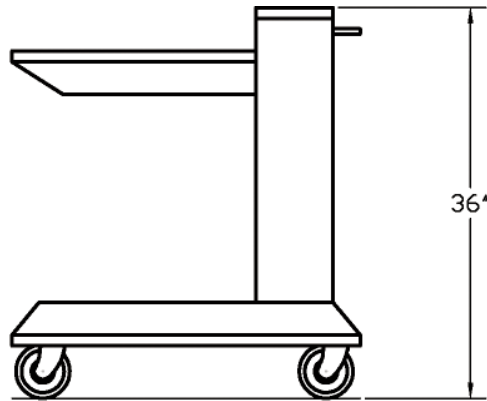

FRONT VIEW

TECHNICAL SPECIFICATIONS

Model Number	Dimensions						Tray/Rack Size	Shpg. Wt. Lbs.
	Platform			Overall				
	W1	L1	H	W	L	H		
36-1014-AF	14½"	10½"	36"	18½"	21⅞"	36"	10" x 14"	108
36-1418-AF	18½"	14½"	36"	30⅝"	19⅝"	36"	14" x 18"	110
36-1622-AF	22½"	16¾"	36"	22⅝"	19⅝"	36"	16" x 22"	110
36-2020-AF	20½"	20½"	36"	32⅝"	23⅝"	36"	20" x 20"	123
36-1020-AF	16¾"	22½"	36"	22⅞"	21⅞"	36"	10" x 20"	110
36-1620-AF	16¾"	20¾"	36"	18½"	32⅞"	36"		110

When ordering:

- Specify model number.
- Specify optional equipment.

BID SPECIFICATIONS

Provide (1) model _____ Tray & Rack Lifter. Unit to be constructed of stainless steel.

Unit to be field adjustable without tools. By connecting the self-contained extension springs, the spring rate can be increased in increments of 1 lb./inch.

OPTIONS

- 5" polyurethane casters, 2 with brakes
- Perimeter bumper
- Silverware dispenser
- Optional correctional package available.



Savannah, TN 38372 www.americanfoodserviceco.com
731-925-2200 / 800-447-4693 / FAX 731-925-2840