



33-101-AF

Roll-in & Pass-Thru Blast Chillers

Roll-In Models

33-101-AF

33-102-AF

Pass-Thru Models

33-101PT-AF

33-102PT-AF

FEATURES

CONTROL PANEL

- HACCP compliant recording features
- Surface mounted on exterior of blast chiller
- On/off switch
- Digital readout of interior ambient temperature
- Digital cycle timer
- Microprocessor control system enclosed in easily accessible box
- Automatic air defrost cycle
- Automatic hold cycle
- Audible alarm at end of chilling cycle

RACK

- Racks provided: 33-101-AF (1), 33-102-AF (2)
- Stainless steel construction
- Accommodates 26 pans, 12" x 20" x 2½", two per each of 13 ledges
- Ledges on 4½" spacing
- Each pan holds up to 10 pounds of food for total rack quantity of 260 lbs.
- Rack dimensions: 24½" wide x 27" deep x 68⅞" high
- Rack mounted on heavy-duty swivel casters

PRODUCT INFORMATION

CONSTRUCTION

- Stainless steel interior and exterior with polyurethane foamed-in-place insulation
- Interior light
- Door gasket heater
- High velocity forced air convection through evaporator coil
- HACCP compliant recording thermometer for blast chiller ambient air temperature (requires printer to have record)
- 4 food temperature probes with sequential readout display in 33-101-AF, 8 probes in 33-102-AF
- Automatic chill cycle control with food temperature probes

DOORS

- Door dimensions: 30" x 78"
- Flush mounted
- 36" high 16 ga. stainless steel kickplate on door exterior

REFRIGERATION SYSTEM

- An air- or water-cooled condensing unit will be supplied depending on application

COOLING TIME

- Maximum load of 260 pounds of food requires approximately 90 minutes per cooling cycle depending on food density and input temperature of food

WARRANTY

- Standard limited one year extended compressor (optional four year extended warranty available), one year limited parts, limited 10 year panel warranty

Roll-in & Pass-Thru Blast Chillers

33-101-AF, 33-102-AF, 33-101PT-AF, 33-102PT-AF

TECHNICAL SPECIFICATIONS

Model	Dimensions (in inches)			Dimensions (in mm)			Volts	MCA	Fuse	Ship Wt. Lb./Kg.
	L	D*	H*	L	D*	H*				
ROLL-IN										
33-101-AF	70	52	89	1778	1194	2184	208-230/1ph/4-wire	9	15	1500/682
33-102-AF	70	98	89	1778	2362	2184	208-230/1ph/4-wire	16	20	3000/1364
PASS-THRU										
33-101PT-AF	70	52	89	1778	1194	2184	208-230/1ph/4-wire	9	15	1500/682
33-102PT-AF	70	98	89	1778	2362	2184	208-230/1ph/4-wire	16	20	3000/1364

*Depth and height include control panel.



HOOKUP

Hardwire, remote refrigeration.

BID SPECIFICATIONS

Item no. 33-_____

Provide _____ () Roll-in or Pass-thru Blast Chiller(s)

Blast chiller to be provided with stainless steel construction and polyurethane foamed-in-place insulation. Blast chiller will feature high velocity forced air convection through evaporator coil.

Probes with sequential readout display will be supplied for food temperature recording (four probes in 33-101-AF model, eight in 33-102-AF).

An automatic chill cycle control with food temperature probes is also supplied.

A thermometer will be provided for recording blast chiller ambient air temperature. Thermometer will require optional printer for record of temperatures.

Roll-in blast chillers will contain one 30" x 78" flush mounted, polyurethane foamed door. Pass-thru models will contain two doors. Doors will be provided with a 36" high 16 ga. stainless steel kickplate on the exterior. Doors will also be supplied with a hold-open feature, magnetic gaskets and gasket heater.

Blast chillers will be provided with an air- or water-cooled condensing unit depending on application requirements.

Blast chiller will be equipped with a standard exterior mounted control panel featuring the following:

- On/off switch
- Digital readout of interior ambient temperature and probe temperatures
- Digital cycle timer for timed chilling
- Microprocessor control system enclosed in easily accessible box
- Automatic defrost cycle and hold cycle
- Audible alarm at end of chilling cycle
- Six programmable one-touch preset chilling programs for easy use

Blast chillers will be supplied with stainless steel racks (one rack for 33-101-AF/33-101PT-AF, two for 33-102-AF/33-102PT-AF) mounted on heavy-duty swivel casters. Racks accommodate 26 pans, 12" x 20" x 2½", two per each of 13 ledges. Each pan holds up to 10 lbs. of food for total rack quantity of 260 lbs. Dimensions of rack are 24½" wide x 27" deep x 68⅞" high.

Blast chillers to have standard limited one year extended compressor warranty (optional four year extended warranty available) with one year limited parts and limited 10 year for panels.



Savannah, TN 38372 www.americanfoodserviceco.com
731-925-2200 / 800-447-4693 / FAX 731-925-2840

Roll-in & Pass-Thru Blast Chillers

33-101-AF, 33-102-AF, 33-101PT-AF, 33-102PT-AF

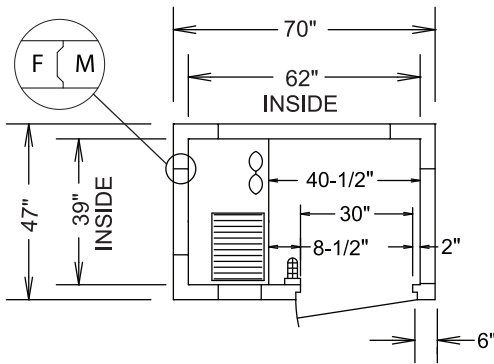

33-101-AF Plan View

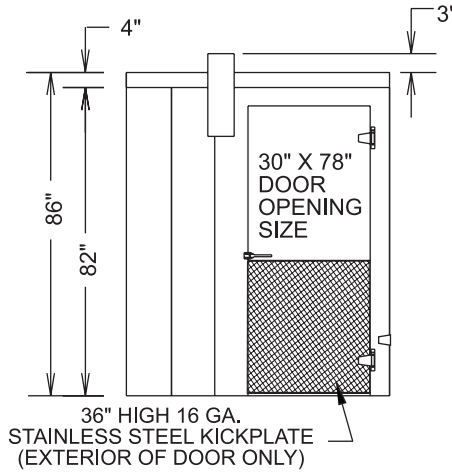

33-101-AF Elevation View

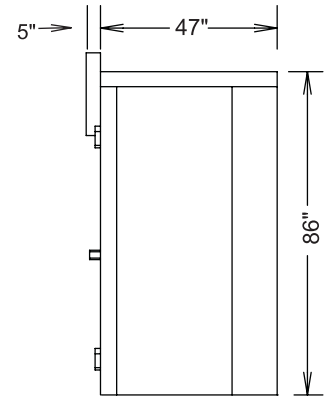

33-101-AF Side View

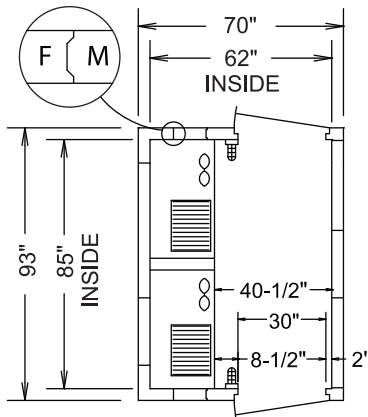

33-102-AF Plan View

DOOR AVAILABLE ON EITHER
SIDE OF WALK-IN

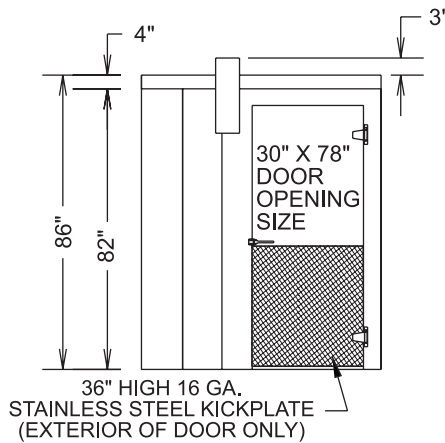

33-102-AF Elevation View

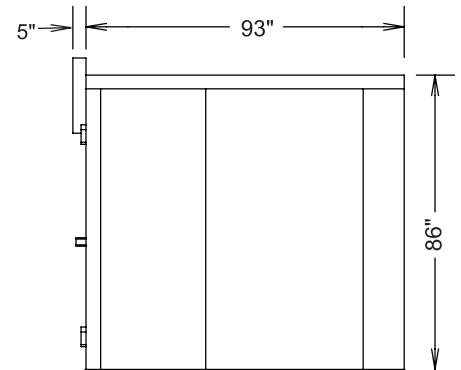

33-102-AF Side View



Savannah, TN 38372 www.americanfoodserviceco.com
731-925-2200 / 800-447-4693 / FAX 731-925-2840

Due to continued product improvement, specifications are subject to change without notice.

9/01/11 USA

Roll-in & Pass-Thru Blast Chillers

33-101-AF, 33-102-AF, 33-101PT-AF, 33-102PT-AF

REFRIGERATION SYSTEM TECHNICAL SPECIFICATIONS

All condensing units must include a suction accumulator. Pull down time reflects time necessary to lower listed quantity of food from 140°F to 40°F. All units listed contain R-404A refrigerant.

COND. UNIT MODEL*	H.P.	BTUH @ -10°F SUCTION TEMP.**	UNIT CONNECTION SIZES		DIMENSIONS SEE DRAWING...	RECEIVER PUMPDOWN CAP. @ 90%	SHIP WT. (LB/KG)	MCA**	MOP**	RLA**	LRA**
			LIQUID	SUCTION							
33-101, 200 LB. CAPACITY, 2 HOUR PULL DOWN TIME											
MSLZ0101C	3	10,653	3/8	7/8	M2	11.4	200/91	20	30	11.1	77
MHLZ0121B	3	11,559	1/2	1 ¹ / ₈	M2	11.4	260/118	30	45	19	105
MCLZ0111B	3	10,372	1/2	7/8	M2	11.4	330/150	24	35	14.7	86
MCLZ0111C	3	10,343	1/2	7/8	M2	11.4	330/150	19	25	10	82
33-101, 200 LB. CAPACITY, 1.5 HOUR PULL DOWN TIME											
MSLZ0151C	4	14,994	1/2	7/8	M2	11.4	230/105	32	40	15	99
BSLZ0400B	4	15,047	1/2	7/8	C	41.5	510/232	42	60	26.8	129
BSLZ0400C	4	15,047	1/2	7/8	C	41.5	510/232	32	40	15	99
BSLZ0400E	4	15,047	1/2	7/8	C	41.5	510/232	20	20	8.2	49.5
BCLZ0280B	3	15,529	5/8	1 ¹ / ₈	C	41.5	505/230	32	40	15	105
BCLZ0280C	3	15,529	5/8	1 ¹ / ₈	C	41.5	505/230	32	35	12.6	112
BCLZ0280E	3	15,529	5/8	1 ¹ / ₈	C	41.5	505/230	20	20	6.2	56
33-101, 250 LB. CAPACITY, 2 HOUR PULL DOWN TIME											
MSLZ0151C	4	14,994	1/2	7/8	M2	11.4	230/105	32	40	15	99
MCLZ0141B	3	13799	1/2	1 ¹ / ₈	M3	11.4	500/227	28	40	16.7	105
MCLZ0141C	3	13903	1/2	1 ¹ / ₈	M3	11.4	500/227	26	35	12.8	112
BSLZ0400B	4	15,047	1/2	7/8	C	41.5	510/232	42	60	26.8	129
BSLZ0400C	4	15,047	1/2	7/8	C	41.5	510/232	32	40	15	99
BSLZ0400E	4	15,047	1/2	7/8	C	41.5	510/232	20	20	8.2	49.5
BCLZ0280B	3	15,529	5/8	1 ¹ / ₈	C	41.5	505/230	32	40	15	105
BCLZ0280C	3	15,529	5/8	1 ¹ / ₈	C	41.5	505/230	32	35	12.6	112
BCLZ0280E	3	15,529	5/8	1 ¹ / ₈	C	41.5	505/230	20	20	6.2	56
33-101, 250 LB. CAPACITY, 1.5 HOUR PULL DOWN TIME											
MSLZ0181C	5	18,945	1/2	1 ¹ / ₈	M3	15.2	240/109	36	55	21.4	123
MDLZ0201C	3	19,518	1/2	1 ¹ / ₈	M5	15.2	530/241	38	45	16.8	102
33-101, 250 LB. CAPACITY, 1.3 HOUR PULL DOWN TIME											
BSLZ0600C	6	21,651	1/2	7/8	C	41.5	550/250	41	60	23.9	156
BCLZ0400C	4	21,531	5/8	1 ³ / ₈	C	41.5	530/230	44	60	26.3	161
BCLZ0400E	4	21,531	5/8	1 ³ / ₈	C	41.5	530/230	22	30	10.2	60
BSLZ0600E	6	21,651	1/2	7/8	C	41.5	550/250	21	25	9.3	70
33-101 250 LB. CAPACITY, LESS THAN 1 HOUR PULL DOWN TIME											
BCLZ0750C	7 ¹ / ₂	37,322	7/8	1 ³ / ₈	D	53.4	730/332	55	80	31.5	161
BCLZ0750E	7 ¹ / ₂	37,322	7/8	1 ³ / ₈	D	53.4	730/332	32	40	16.1	83
33-101 250 LB. CAPACITY, LESS THAN 1 HOUR PULL DOWN TIME - WATER COOLED CONDENSING UNITS											
SCLZ075WC	7 ¹ / ₂	39,600	5/8	1 ³ / ₈	D	78.4	730/332	50	80	31.5	161
SCLZ075WE	7 ¹ / ₂	39,600	5/8	1 ³ / ₈	D	78.4	750/341	32	40	16.1	83
33-102, 400 LB. CAPACITY, 2 HOUR PULL DOWN TIME											
MSLZ0221C	6	23,018	1/2	1 ¹ / ₈	M5	22.1	250/114	39	60	23.9	156
MDLZ0231C	4	22,958	1/2	1 ¹ / ₈	M5	15.2	530/241	42	60	26.3	161
BCLZ040LC	4	23,171	5/8	1 ³ / ₈	C	41.5	530/241	45	70	26.3	161
33-102, 400 LB. CAPACITY, 1.5 HOUR PULL DOWN TIME											
MDLZ0291C	6	29,187	5/8	1 ³ / ₈	M5	22.1	560/255	47	70	28.2	161
33-102, 500 LB. CAPACITY, 2 HOUR PULL DOWN TIME											
MDLZ0291C	6	29,187	5/8	1 ³ / ₈	M5	22.1	560/255	47	70	28.2	161
BSLZ0750C	7 ¹ / ₂	26,006	7/8	1 ³ / ₈	D	53.4	600/272	45	60	23.4	189
BCLZ0600C	6	26,466	5/8	1 ³ / ₈	C	41.5	560/255	46	70	28.2	161
BCLZ0600E	6	26,466	5/8	1 ³ / ₈	C	41.5	560/255	26	35	13.3	80

***VOLTAGE KEY:**

"B" suffix = 208-230 or 230 volt, 60 cycle, one phase

"C" suffix = 200-230 or 208-230 volt, 60 cycle, three phase

"E" suffix = 460 volt, 60 cycle, three phase

**Based on 90°F ambient

***Electrical ratings for condensing unit only. See National Electrical Code if units are combined on a single circuit.



Savannah, TN 38372 www.americanfoodserviceco.com
731-925-2200 / 800-447-4693 / FAX 731-925-2840

Roll-in & Pass-Thru Blast Chillers

33-101-AF, 33-102-AF, 33-101PT-AF, 33-102PT-AF

REFRIGERATION SYSTEM TECHNICAL SPECIFICATIONS, cont.

COND. UNIT MODEL*	H.P.	BTUH @ -10°F SUCTION TEMP.**	UNIT CONNECTION SIZES		DIMENSIONS SEE DRAWING... (PP. 4-5)	RECEIVER PUMPDOWN CAP. @ 90%	SHIP WT. (LB/KG)	MCA**	MOP**	RLA**	LRA**
			LIQUID	SUCTION							
33-102, 500 LB. CAPACITY, 1.5 HOUR PULL DOWN TIME											
MDLZ0331C	6	32,417	5/8	1 ³ / ₈	M5	22.1	560/255	50	70	30.3	150
BCLZ0750C	7 ¹ / ₂	37,322	7/8	1 ³ / ₈	D	53.4	730/332	55	80	31.5	161
BCLZ0750E	7 ¹ / ₂	36,200	7/8	1 ³ / ₈	D	53.4	730/332	32	40	16.1	83
33-102, 500 LB. CAPACITY, LESS THAN 1 HOUR PULL DOWN TIME											
BCLZ1500C	15	70,782	7/8	1 ⁵ / ₈	F	116.1	990/450	90	125	52.6	278
BCLZ1500E	15	70,782	7/8	1 ⁵ / ₈	F	116.1	990/450	51	70	26.3	139
33-102, 500 LB. CAPACITY, LESS THAN 1 HOUR PULL DOWN TIME – WATER-COOLED CONDENSING UNITS											
SCLZ100WC	10	54,800	7/8	1 ³ / ₈	E	105.3	743/338	66	100	42	215
SCLZ100WE	10	54,800	7/8	1 ³ / ₈	E	105.3	910/414	34	50	18.6	106

*VOLTAGE KEY:

"B" suffix = 208-230 or 230 volt, 60 cycle, one phase

"C" suffix = 200-230 or 208-230 volt, 60 cycle, three phase

"E" suffix = 460 volt, 60 cycle, three phase

**Based on 90°F ambient

***Electrical ratings for condensing unit only. See National Electrical Code if units are combined on a single circuit.

Base "C"

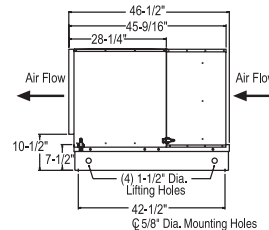
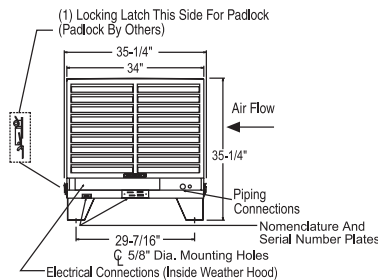

Base "D"

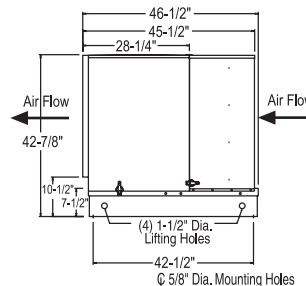
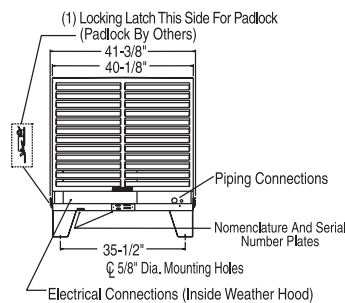

Base "E"

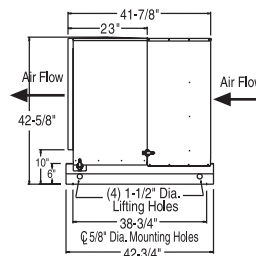
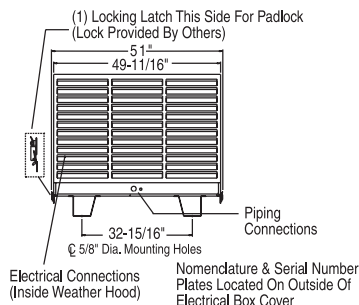

Savannah, TN 38372 www.americanfoodserviceco.com
731-925-2200 / 800-447-4693 / FAX 731-925-2840

Due to continued product improvement, specifications are subject to change without notice.

9/01/11 USA

Roll-in & Pass-Thru Blast Chillers

33-101-AF, 33-102-AF, 33-101PT-AF, 33-102PT-AF

Base "F"

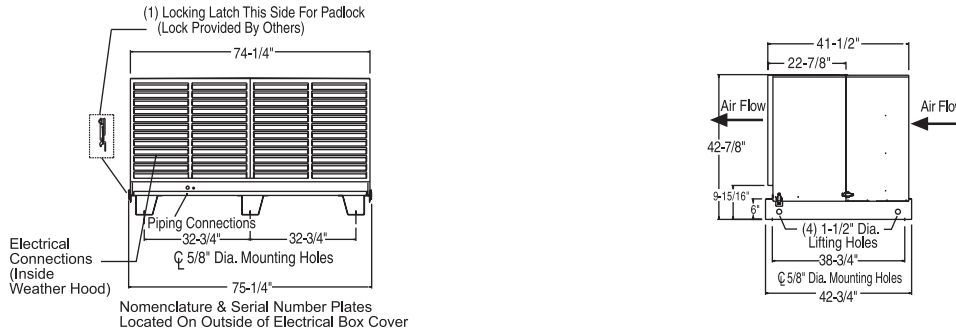

Base "M2"

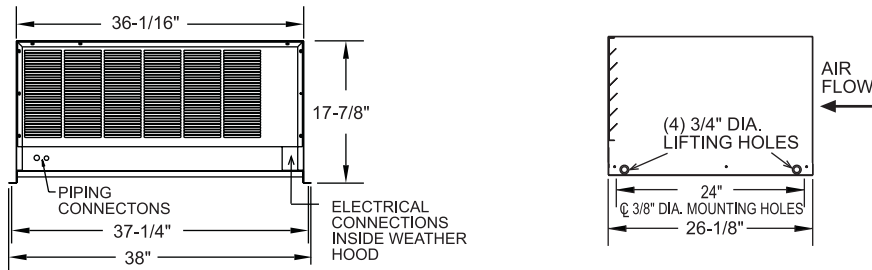

Base "M3"

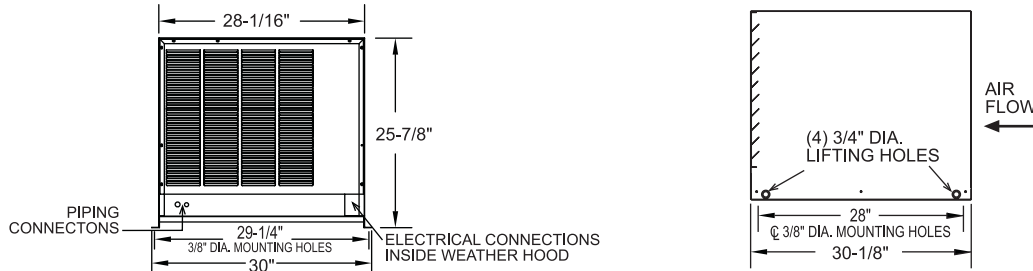

Base "M5"

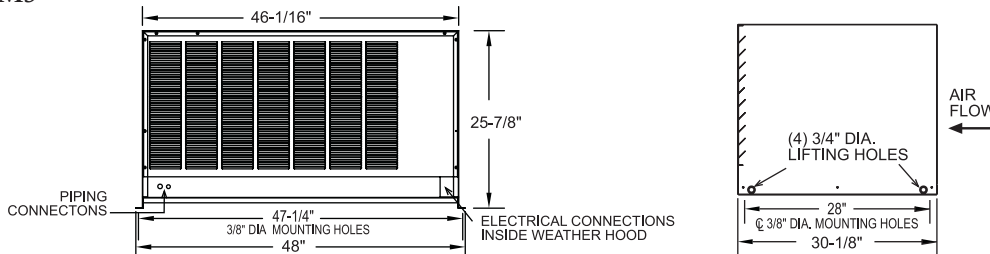

Savannah, TN 38372 www.americanfoodserviceco.com
731-925-2200 / 800-447-4693 / FAX 731-925-2840

Due to continued product improvement, specifications are subject to change without notice.

9/01/11 USA